

# REVERE COMMERCIAL

## CITYVILLE GREENVILLE Lowest Greenville Dallas, TX



6,000 SF  
End Cap  
For Lease



**Property Summary:**

- 6,000 SF of End Cap Space For Lease
- 6.5 per 1,000 SF of Parking Space - 98 Parks
- GIGANTIC Visibility
- Competitive Rental Rates
- 3 level Mixed Use Development
- 128 MF Units/12 Town Homes

**Traffic Counts:**

Greenville: 25,995 vpd  
 Ross: 26,196 vpd  
 Counts provided by: City of Dallas

**Demographics**

	1 mile	3 mile	5 mile
--	--------	--------	--------

Population	39,174	173,822	391,205
Households	14,007	76,182	155,707
Avg. Household Income	\$63,932	\$95,866	\$86,435

**Patric Turner**

214.696.2510

# REVERE COMMERCIAL

## CITYVILLE GREENVILLE Lowest Greenville Dallas, Texas

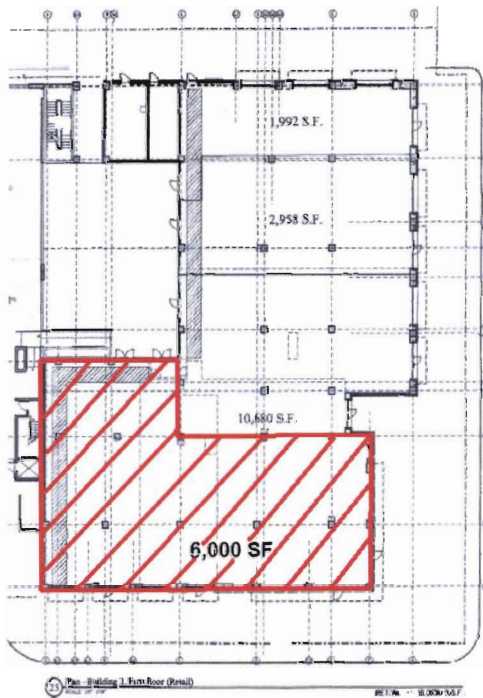

Greenville Avenue

Lewis Street

